

Blackpool Council

12 OCT 2018

APPLICATION TO VARY A PREMISES LICENCE

Applicant Name(s):

FRANCIS THOMAS KELLY.



Licensing Service
Blackpool Council
Municipal Buildings, PO Box 4
Blackpool, FY1 1NA

Contact

T: (01253) 47 8572 / 8589
F: (01253) 47 8372

www.blackpool.gov.uk/licensing

Application to vary a Premises Licence under the Licensing Act 2003

Please read the following instructions first:

Before completing this form please read the guidance notes at the end of this form. If you are completing this form by hand please write legibly in block capitals. In all cases ensure that your answers are inside the boxes and written in black ink. Use additional sheets if necessary. You may wish to keep a copy of the completed form for your records.

Full name/s of the premises licence holder/s:

FRANCIS THOMAS KELLY.

I/We the premises licence holder/s named above, apply to vary a premises licence under section 34 of the Licensing Act 2003 for the premises described in Part 1

Premises Licence number:

PL 1486.

Part 1 – Premises Details

Premises Address	NUMBER 3.					
	DEVONSHIRE SQUARE					
	BRACPOLE	Post Code	F	Y	3	9 B W
Telephone Number of premises (if any)	[REDACTED]					
Non-domestic rateable value of premises	[REDACTED]					

Part 2 – Applicant details

Title:	<input checked="" type="radio"/> Mr	<input type="radio"/> Mrs	<input type="radio"/> Miss	<input type="radio"/> Ms	<input type="radio"/> Other	Forename(s)	FRANCIS THOMAS
Surname	KELLY					Date of Birth	Day Month Year
Home address	[REDACTED]						
	[REDACTED]						
	Post Code	[REDACTED]					
Telephone Number	[REDACTED]				Mobile Number	[REDACTED]	
E-Mail address	[REDACTED]						

Part 3 – Variation

If yes please tick

Do you want the proposed variation to have effect as soon as possible?

☒

If not, when do you want the variation to take effect from?

Day		Month		Year	

Do you want the proposed variation to have effect in relation to the introduction of the late night levy? (Please see guidance note 1)

☐

If your proposed variation would mean that 5,000 or more people could be expected to attend the premises at any one time, please state the number expected to attend

Please describe briefly the nature of the proposed variation (Please see guidance note 1)

INCREASE HOURS OF OPERATION ON THURSDAYS AND SUNDAYS TO 01.00 AM AND FRIDAY AND SATURDAY TO 02.00 AM

CHANGE / REMOVE CONDITIONS IN OPERATING SCHEDULE.
ANNEX II

ADD AN AGE POLICY.

EXTEND CONDITION FOR CCTV

REVISED LAYOUT OF PREMISES' LICENSED AREA, AS PER PLAN

Part 4 – Operating Schedule

Please complete those parts of the Operating Schedule below that would be subject to change if this application to vary is successful.

Provision of regulated entertainment (please see guidance note 3):

If yes please tick

- a) A performance of a play (if ticking yes, fill in box A) ☐
- b) An exhibition of a film (if ticking yes, fill in box B) ☐
- c) An indoor sporting event (if ticking yes, fill in box C) ☐
- d) Boxing or wrestling entertainment (if ticking yes, fill in box D) ☐
- e) A performance of live music (if ticking yes, fill in box E) ☒
- f) Any playing of recorded music (if ticking yes, fill in box F) ☒
- g) A performance of dance (if ticking yes, fill in box G) ☐
- h) Entertainment of a similar description to that falling within (e), (f) or (g) (if ticking yes, fill in box H) ☐

Provision of late night refreshment (if ticking yes, fill in box I)

☐

Sale by retail of alcohol (if ticking yes, fill in box J)

☒

In all cases complete boxes K, L, and M

A

Plays Standard days and timings (please read guidance note 8)			Will the performance of a play take place indoors, outdoors or both – please tick accordingly (Please read guidance note 4)	Indoors	
Day	Start	Finish		Outdoors	
Mon			Please give further details here (please read guidance note 5)	Both	
Tue					
Wed					
Thu			State any seasonal variation for performing plays (please read guidance note 6)		
Fri					
Sat					
Sun			Non-standard timings. Where you intend to use the premises for the performance of plays at different times to those listed in the column on the left, please list (please see guidance note 7)		

D

Boxing or wrestling entertainment Standard days and timings (please read guidance note 8)			Will the boxing or wrestling entertainment take place indoors, outdoors or both – please tick accordingly (Please read guidance note 4)	Indoors	
				Outdoors	
				Both	
Day	Start	Finish	Please give further details here (please read guidance note 5)		
Mon					
Tue					
Wed			State any seasonal variation for boxing or wrestling entertainment (please read guidance note 8)		
Thu					
Fri					
Sat			Non-standard timings. Where you intend to use the premises for boxing or wrestling entertainment at different times to those listed in the column on the left, please list (please see guidance note 7)		
Sun					

E

Live music Standard days and timings (please read guidance note 8)			Will the performance of live music take place indoors, outdoors or both – please tick accordingly (Please read guidance note 4)	Indoors	<input checked="" type="checkbox"/>
				Outdoors	
				Both	
Day	Start	Finish	Please give further details here (please read guidance note 5)		
Mon					
Tue					
Wed			State any seasonal variation for performance of live music (please read guidance note 6)		
Thu	16.00	01.00			
Fri	10.00	02.00			
Sat	10.00	02.00	Non-standard timings. Where you intend to use the premises for the performance of live music at different times to those listed in the column on the left, please list (please see guidance note 7) ON BANK HOLIDAY SUNDAYS, CHRISTMAS EVE, BOXING DAY AND NEW YEARS EVE TO 0200.		
Sun	10.00	01.00			

Recorded music Standard days and timings (please read guidance note 8)			Will the performance of recorded music take place indoors, outdoors or both – please tick accordingly (Please read guidance note 4)		Indoors	<input checked="" type="checkbox"/>
					Outdoors	<input type="checkbox"/>
					Both	<input type="checkbox"/>
Day	Start	Finish	Please give further details here (please read guidance note 5)			
Mon						
Tue						
Wed			State any seasonal variation for playing recorded music (please read guidance note 6)			
Thu	10.00	01.00				
Fri	10.00	02.00	Non-standard timings. Where you intend to use the premises for the playing of recorded music at different times to those listed in the column on the left, please list (please see guidance note 7) ON BANK HOLIDAY SUNDAYS, CHRISTMAS EVE, BOXING DAY AND NEW YEARS EVE TO 0200			
Sat	10.00	02.00				
Sun	10.00	01.00				

G

Performances of dance Standard days and timings (please read guidance note 8)			Will the performance of dance take place indoors, outdoors or both – please tick accordingly (Please read guidance note 4)		Indoors	<input type="checkbox"/>
					Outdoors	<input type="checkbox"/>
					Both	<input type="checkbox"/>
Day	Start	Finish	Please give further details here (please read guidance note 5)			
Mon						
Tue						
Wed			State any seasonal variation for the performance of dance (please read guidance note 6)			
Thu						
Fri			Non-standard timings. Where you intend to use the premises for the performance of dance at different times to those listed in the column on the left, please list (please see guidance note 7)			
Sat						
Sun						

J

Supply of alcohol Standard days and timings (please read guidance note 8)			Will the sale of alcohol for consumption be on the premises, off the premises or both (Please read guidance note 9)	On the Premises	
Day	Start	Finish		Off the premises	
Mon			State any seasonal variation for the supply of alcohol (please read guidance note 6)	Both	<input checked="" type="checkbox"/>
Tue					
Wed			Non-standard timings. Where you intend to use the premises for the supply of alcohol at different times to those listed in the column on the left, please list (please see guidance note 7)		
Thu	10.00	01.00			
Fri	10.00	02.00	BANK HOLIDAY SUNDAYS, CHRISTMAS EVE, BOXING DAY AND NEW YEARS EVE TO 02.00.		
Sat	10.00	02.00			
Sun	10.00	01.00			

K

Please highlight any adult entertainment or services, activities, other entertainment or matter ancillary to the use of the premises that may give rise to concern in respect of children (please read guidance note 10)
NONE

Hours premises are open to the public			State any seasonal variations (please read guidance note 6)
Day	Start	Finish	
Mon			<p>Non-standard timings. Where you intend to use the premises to be open to the public at different times to those listed in the column on the left, please list (please see guidance note 7)</p> <p>ON BANK HOLIDAY SUNDAYS TO 02.30</p> <p>ON CHRISTMAS EVE, BOXING DAY AND NEW YEAR'S EVE TO 02.30</p>
Tue			
Wed			
Thu	10.00	01.30	
Fri	10.00	02.30	
Sat	10.00	02.30	
Sun	10.00	01.30	

Please identify those conditions currently imposed on the licence that you believe could be removed as a consequence of the proposed variation you are seeking

Annex II - Remove condition 3 and amend conditions 4 and 7 on basis that Mitchell & Butler company policies are not relevant

I have enclosed the existing premises licence and summary

If yes please tick



I have enclosed the relevant part of the premises licence



If you have not ticked one of these boxes you are required to give your reasons for not including the licence, or any part of it below.

Reasons why I have failed to enclose the premises licence or relevant part of the premises licence

CHARITITY WITH BLACKPOOL COUNCIL FOR CHANGE OF LICENCE HOLDER

M

Describe any additional steps you intend to take to promote the four licensing objectives as a result of the proposed variation:

a) General – all four licensing objectives (b,c,d,e) (See guidance note 11)

SEE ATTACHED

b) The prevention of crime and disorder

SEE ATTACHED

c) Public Safety

SEE ATTACHED

d) The prevention of public nuisance

SEE ATTACHED

e) The protection of children from harm

SEE ATTACHED

If yes please tick

- I have made or enclosed payment of the fee, or I have not made or enclosed payment of the fee because this application has been made in relation to the introduction of the late night levy ☒
- I have sent copies of this application, a copy of the plan and a photocopy of the existing premises licence to responsible authorities and others where applicable ☒
- I understand that I must advertise my application ☒
- I have enclosed the premises licence or relevant part of it or an explanation why not ☐
- I understand that if I do not comply with the above requirements my application will be rejected ☒

IT IS AN OFFENCE, UNDER SECTION 158 OF THE LICENSING ACT 2003, TO MAKE A FALSE STATEMENT IN OR IN CONNECTION WITH THIS APPLICATION. THOSE WHO MAKE A FALSE STATEMENT MAY BE LIABLE ON SUMMARY CONVICTION TO A FINE OF ANY AMOUNT.

Part 5 – Signatures (please read guidance note 12)

Signature of applicant (the current premises licence holder) or applicant's solicitor or other duly authorised agent (please read guidance note 13). If signing on the behalf of the applicant please state in what capacity.

Signed	
Print Name	MICHAEL WOOSNAM
Capacity	SOLICITOR FOR APPLICANT
Date	11/10/2018

Where the premises licence is jointly held signature of 2nd applicant (the current premises licence holder) or 2nd applicant's solicitor or other authorised agent (please read guidance note 14). If signing on behalf of the applicant please state in what capacity.

Signed	
Print Name	
Capacity	
Date	

Contact name (where not previously given) and address for correspondence associated with this application. (Please read guidance note 15)

Title:	<input checked="" type="radio"/> Mr	<input type="radio"/> Mrs	<input type="radio"/> Miss	<input type="radio"/> Ms	<input type="radio"/> Other					
Forenames	MICHAEL				Surname	WOOSNAM				
Address for Correspondence associated with this application	ROLAND ROBINSONS & FENTONS									
	87 ADELAIDE STREET									
	B LACLOUGH				Post Code	F	Y	1		4
Telephone Number	01253 621432				Mobile Number					
E-Mail Address	mwc@rfsolicitors.com									

The Number 3, Devonshire Square, Blackpool
Proposed changes to conditions

12 OCT 2012

Annex 2

REMOVE THE EXISITING CONDITIONS—3, 4, and 10.

AMEND CONDITION 7 BY REMOVING THE WORDS “in line with the Company’s current procedures.”

ADD THE FOLLOWING CONDITIONS BY WAY OF REPLACEMENT AND ADDITIONAL CONDITIONS

1. CCTV will be installed internally and externally at the premises and will comply with the following: -

- The CCTV system shall be installed, maintained and operated to the reasonable satisfaction of Lancashire Constabulary. All public areas of the premises are to be covered by the system.
- The system will display on any recording the correct time and date of the recording.
- The system will make recordings during all hours that the premises are open to the public.
- The VCR tapes or digital recording will be held for a minimum of 31 days and 28 days respectively after the recording is made and will be made available to the police or any authorized persons acting for a responsible authority for inspection upon request.
- The system will, as a minimum, record images of the head and shoulders of all persons entering the premises.

A staff member who is conversant with the operation of the CCTV system will be on the premises at all times that the premises are open to the public. This staff member will be able to show police recent data or footage with the absolute minimum of delay, when requested.

The Licence Holder or Designated Premises Supervisor will notify the Police Licensing Unit on any occasion when the CCTV is to be inoperative for a period in excess of one working day and shall provide a certificate

from a competent person stating the reason for the system being inoperative and the measures which have been taken to satisfy the licence conditions.

Appropriate signs informing customers that CCTV is recording will be displayed in conspicuous positions on the premises.

Monthly documented maintenance checks of the CCTV system, including the recording system, will be carried out by the Designated Premises Supervisor to ensure that the system is in good working order and fit for purpose.

2. The Local Authority CCTV control room will be notified: -

- a) On any occasion when the premises CCTV or radio system is inoperative
- b) When the CCTV or radio system has been brought back into use.

3. The Police Licensing Unit shall be notified on any occasion when the CCTV or radio system is to be inoperative for a period in excess of one working day and a certificate from a competent person shall be provided stating the reason for the system being so inoperative and the measures which have been taken to satisfy the licence conditions.

4. The premises are to be operated in accordance with the principles outlined by the Nightsafe scheme as are relevant to the premises and indicated in the associated leaflet.

5. An adequate number of Licensed door supervisors will be on duty as appropriate to any risk assessment and in accordance with the guidance under the 'Nightsafe' Scheme.

6. The licence holder is to support and rigorously enforce the Challenge 25 proof of age policy.

7. Any person who looks or appears to be under the age of 25 shall be asked to provide identification that they are over the age of 18. The following are the only forms of identification acceptable: -

- i. UK photo driving licence.
- ii. Passport.
- iii. Proof of Age Standards Scheme card.

8. All staff will receive suitable training in relation to the proof of age scheme to be applied upon the premises. Records to evidence this will be made available to an authorized officer on request.

LICENSING PLAN

N

RIN
J.E.C.

PROPOSED_1:100

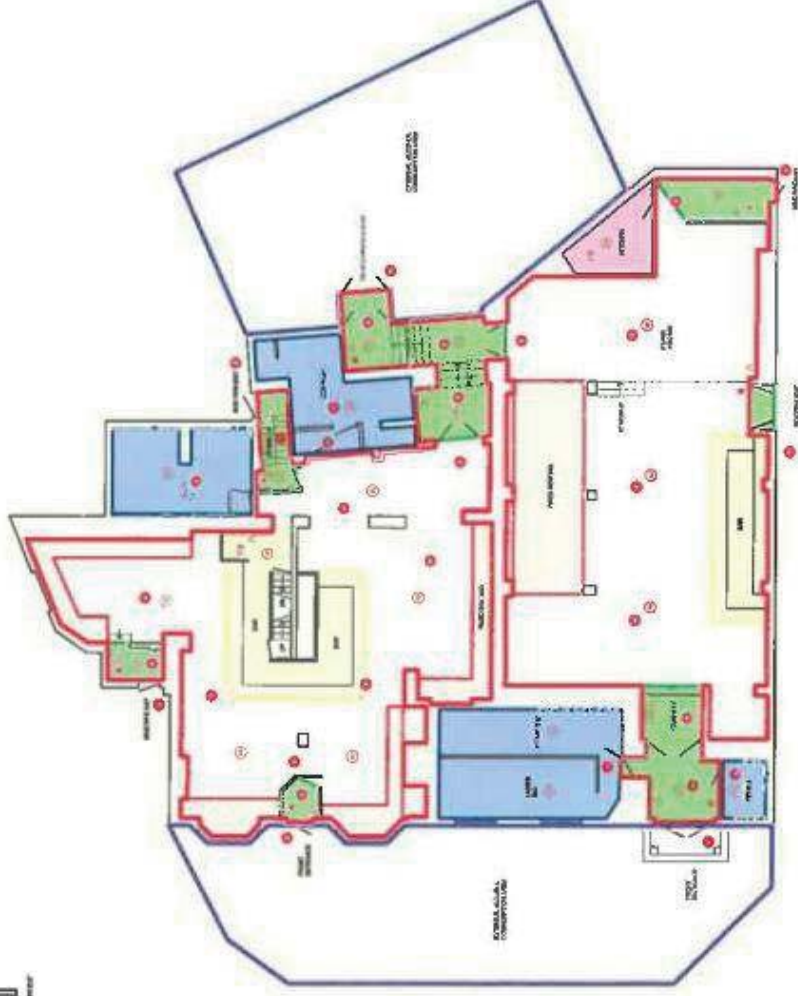

DRAWING TITLE	
LICENSING PLAN FOR APPROVAL OF EXISTING PLANS	
PROJECT	
THE VILLAGE TRISTE PAV, WENTWORTH (B&B),	
WENTWORTH, 1711 10th	
W. JURY	
WENTWORTH GROUP	
PROJECT	
LICENSING PLAN FOR APPROVAL	
SCALE	DATE
1:100 1:200	2017 2018
1:500 1:1000	2019 2020
DATE	DATE
2017 2018	2019 2020
2021 2022	2023 2024
2025 2026	2027 2028
2029 2030	2031 2032
2033 2034	2035 2036
2037 2038	2039 2040
2041 2042	2043 2044
2045 2046	2047 2048
2049 2050	2051 2052
2053 2054	2055 2056
2057 2058	2059 2060
2061 2062	2063 2064
2065 2066	2067 2068
2069 2070	2071 2072
2073 2074	2075 2076
2077 2078	2079 2080
2081 2082	2083 2084
2085 2086	2087 2088
2089 2090	2091 2092
2093 2094	2095 2096
2097 2098	2099 2100
2101 2102	2103 2104
2105 2106	2107 2108
2109 2110	2111 2112
2113 2114	2115 2116
2117 2118	2119 2120
2121 2122	2123 2124
2125 2126	2127 2128
2129 2130	2131 2132
2133 2134	2135 2136
2137 2138	2139 2140
2141 2142	2143 2144
2145 2146	2147 2148
2149 2150	2151 2152
2153 2154	2155 2156
2157 2158	2159 2160
2161 2162	2163 2164
2165 2166	2167 2168
2169 2170	2171 2172
2173 2174	2175 2176
2177 2178	2179 2180
2181 2182	2183 2184
2185 2186	2187 2188
2189 2190	2191 2192
2193 2194	2195 2196
2197 2198	2199 2200
2201 2202	2203 2204
2205 2206	2207 2208
2209 2210	2211 2212
2213 2214	2215 2216
2217 2218	2219 2220
2221 2222	2223 2224
2225 2226	2227 2228
2229 2230	2231 2232
2233 2234	2235 2236
2237 2238	2239 2240
2241 2242	2243 2244
2245 2246	2247 2248
2249 2250	2251 2252
2253 2254	2255 2256
2257 2258	2259 2260
2261 2262	2263 2264
2265 2266	2267 2268
2269 2270	2271 2272
2273 2274	2275 2276
2277 2278	2279 2280
2281 2282	2283 2284
2285 2286	2287 2288
2289 2290	2291 2292
2293 2294	2295 2296
2297 2298	2299 2300
2301 2302	2303 2304
2305 2306	2307 2308
2309 2310	2311 2312
2313 2314	2315 2316
2317 2318	2319 2320
2321 2322	2323 2324
2325 2326	2327 2328
2329 2330	2331 2332
2333 2334	2335 2336
2337 2338	2339 2340
2341 2342	2343 2344
2345 2346	2347 2348
2349 2350	2351 2352
2353 2354	2355 2356
2357 2358	2359 2360
2361 2362	2363 2364
2365 2366	2367 2368
2369 2370	2371 2372
2373 2374	2375 2376
2377 2378	2379 2380
2381 2382	2383 2384
2385 2386	2387 2388
2389 2390	2391 2392
2393 2394	2395 2396
2397 2398	2399 2400
2401 2402	2403 2404
2405 2406	2407 2408
2409 2410	2411 2412
2413 2414	2415 2416
2417 2418	2419 2420
2421 2422	2423 2424
2425 2426	2427 2428
2429 2430	2431 2432
2433 2434	2435 2436
2437 2438	2439 2440
2441 2442	2443 2444
2445 2446	2447 2448
2449 2450	2451 2452
2453 2454	2455 2456
2457 2458	2459 2460
2461 2462	2463 2464
2465 2466	2467 2468
2469 2470	2471 2472
2473 2474	2475 2476
2477 2478	2479 2480
2481 2482	2483 2484
2485 2486	2487 2488
2489 2490	2491 2492
2493 2494	2495 2496
2497 2498	2499 2500
2501 2502	2503 2504
2505 2506	2507 2508
2509 2510	2511 2512
2513 2514	2515 2516
2517 2518	2519 2520
2521 2522	2523 2524
2525 2526	2527 2528
2529 2530	2531 2532
2533 2534	2535 2536
2537 2538	2539 2540
2541 2542	2543 2544
2545 2546	2547 2548
2549 2550	2551 2552
2553 2554	2555 2556
2557 2558	2559 2560
2561 2562	2563 2564
2565 2566	2567 2568
2569 2570	2571 2572
2573 2574	2575 2576
2577 2578	2579 2580
2581 2582	2583 2584
2585 2586	2587 2588
2589 2590	2591 2592
2593 2594	2595 2596
2597 2598	2599 2600
2601 2602	2603 2604
2605 2606	2607 2608
2609 2610	2611 2612
2613 2614	2615 2616
2617 2618	2619 2620
2621 2622	2623 2624
2625 2626	2627 2628
2629 2630	2631 2632
2633 2634	2635 2636
2637 2638	2639 2640
2641 2642	2643 2644
2645 2646	2647 2648
2649 2650	2651 2652
2653 2654	2655 2656
2657 2658	2659 2660
2661 2662	2663 2664
2665 2666	2667 2668
2669 2670	2671 2672
2673 2674	2675 2676
2677 2678	2679 2680
2681 2682	2683 2684
2685 2686	2687 2688
2689 2690	2691 2692
2693 2694	2695 2696
2697 2698	2699 2700
2701 2702	2703 2704
2705 2706	2707 2708
2709 2710	2711 2712
2713 2714	2715 2716
2717 2718	2719 2720
2721 2722	2723 2724
2725 2726	2727 2728
2729 2730	2731 2732
2733 2734	2735 2736
2737 2738	2739 2740
2741 2742	2743 2744
2745 2746	2747 2748
2749 2750	2751 2752
2753 2754	2755 2756
2757 2758	2759 2760
2761 2762	2763 2764
2765 2766	2767 2768
2769 2770	2771 2772
2773 2774	2775 2776
2777 2778	2779 2780
2781 2782	2783 2784
2785 2786	2787 2788
2789 2790	2791 2792
2793 2794	2795 2796
2797 2798	2799 2800
2801 2802	2803 2804
2805 2806	2807 2808
2809 2810	2811 2812
2813 2814	2815 2816
2817 2818	2819 2820
2821 2822	2823 2824
2825 2826	2827 2828
2829 2830	2831 2832
2833 2834	2835 2836
2837 2838	2839 2840
2841 2842	2843 2844
2845 2846	2847 2848
2849 2850	2851 2852
2853 2854	2855 2856
2857 2858	2859 2860
2861 2862	2863 2864
2865 2866	2867 2868
2869 2870	2871 2872
2873 2874	2875 2876
2877 2878	2879 2880
2881 2882	2883 2884
2885 2886	2887 2888
2889 2890	2891 2892
2893 2894	2895 2896
2897 2898	2899 2900
2901 2902	2903 2904
2905 2906	2907 2908
2909 2910	2911 2912
2913 2914	2915 2916
2917 2918	2919 2920
2921 2922	2923 2924
2925 2926	2927 2928
2929 2930	2931 2932
2933 2934	2935 2936
2937 2938	2939 2940
2941 2942	2943 2944
2945 2946	2947 2948
2949 2950	2951 2952
2953 2954	2955 2956
2957 2958	2959 2960
2961 2962	2963 2964
2965 2966	2967 2968
2969 2970	2971 2972
2973 2974	2975 2976
2977 2978	2979 2980
2981 2982	2983 2984
2985 2986	2987 2988
2989 2990	2991 2992
2993 2994	2995 2996
2997 2998	2999 3000
3001 3002	3003 3004
3005 3006	3007 3008
3009 3010	3011 3012
3013 3014	3015 3016
3017 3018	3019 3020
3021 3022	3023 3024
3025 3026	3027 3028
3029 3030	3031 3032
3033 3034	3035 3036
3037 3038	3039 3040
3041 3042	3043 3044
3045 3046	3047 3048
3049 3050	3051 3052
3053 3054	3055 3056
3057 3058	3059 3060
3061 3062	3063 3064
3065 3066	3067 3068
3069 3070	3071 3072
3073 3074	3075 3076
3077 3	